

PLEASE READ

This manual is provided as a free service by Projector.com.

We are in no way responsible for the contents of the manual. We do not guarantee its accuracy and we do not make any claim of copyright. The copyright remains the property of their respective owners.

ABOUT PROJECTOR.COM

Projector.com (<http://www.projector.com>) is your review and buying guide resource for DLP and LCD video projectors.

Visit the site to read the latest projector news and reviews, read and comment on projector specifications, download user manuals and much more.

BARCO

BARCO PROJECTION SYSTEMS

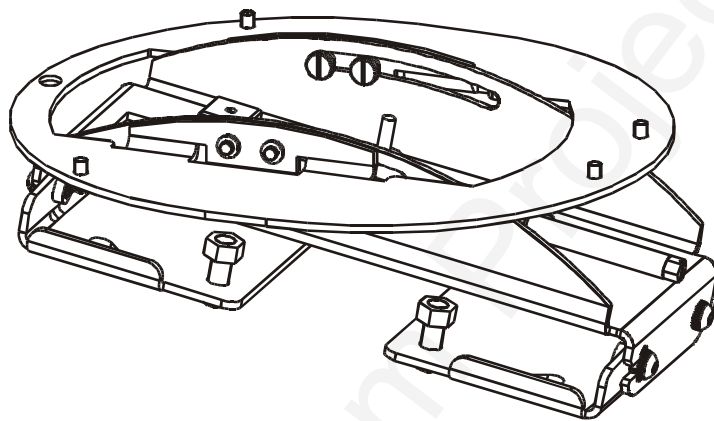

BARCO

Ceiling Mount Kit
Cine Versum 80

R9841750

INSTALLATION MANUAL

Ceiling Mount for Cine Versum Projectors

Due to constant research, the information in this manual is subject to change without notice.

Produced by BARCO NV, Oct. 2002.
All rights reserved.

Trademarks are the rights of their respective owners.

BARCO n.v./Projection Systems

Noordlaan 5
B-8520 Kuurne
Belgium

Tel: +32/56/368211

Fax: +32/56/351651

E-mail: sales.bps@barco.com

Visite Barco at the web: <http://www.barco.com>

Printed in Belgium

Safety Guidelines

Caution



This frame is designed for use only with the Barco Cine Versum series projectors. Use with other appliances may result in instability causing possible injury. The ceiling mount supports max.25kg(55LB)

Warning



The ceiling should be capable of supporting a weight of at least 125 kg (275LB) if it cannot, the ceiling must be reinforced. Improper installation may result in serious personal injury

Description and Contents of the kit

Purpose of the Kit

The kit is designed for the Cine Versum series projectors and allows the projector to be mounted to the ceiling.

Contents of the Kit

Following items are included.

- Kit R9841750: ceiling mount
- Hexagonal nut spanner of 8mm
- Installation manual : R5976501
- Set of spacer, bearing and fastner
- Safety Chain set

Illustration of the ceiling mount

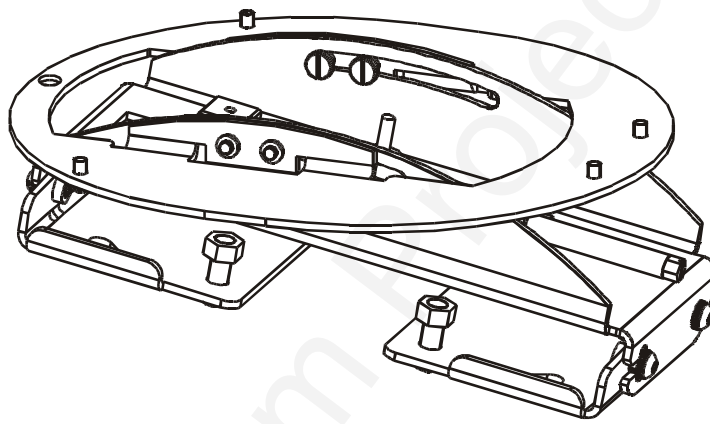

Remark

The ceiling mount can also be mounted using one of the 2 available bars (height adjustment):

R9841260: short bar R822922

min length = 400mm(15.75 inch)
max length = 765 mm(30.10 inch)

R9841261: long bar R822923

min length = 800mm(31.50 inch)
max length = 1165 mm(45.85 inch)

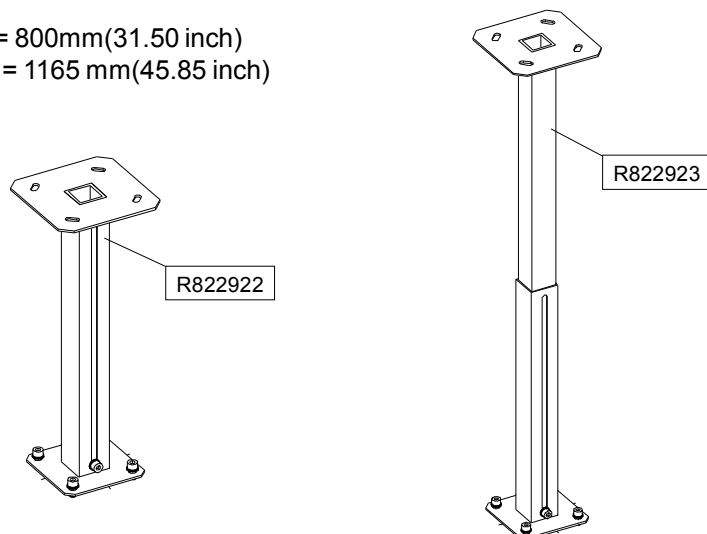

Mounting the Assembly

What has to be done The ceiling mount kit is first disassembled into the ceiling plate and projector base plate as shown.

Necessary Tools Hexagonal key (n°4), flat screwdriver

Centering the ceiling mount Before fixing the base plate, the ceiling mount (thus the projector) has to be centered according to the screen. Since the center of the lens does not coincide with the center of the projector.

Step	Action	Image
1	Mark the position on the ceiling, knowing the center of the lens (which doesn't coincide with the center of the ceiling mount, see drawing) below.	1

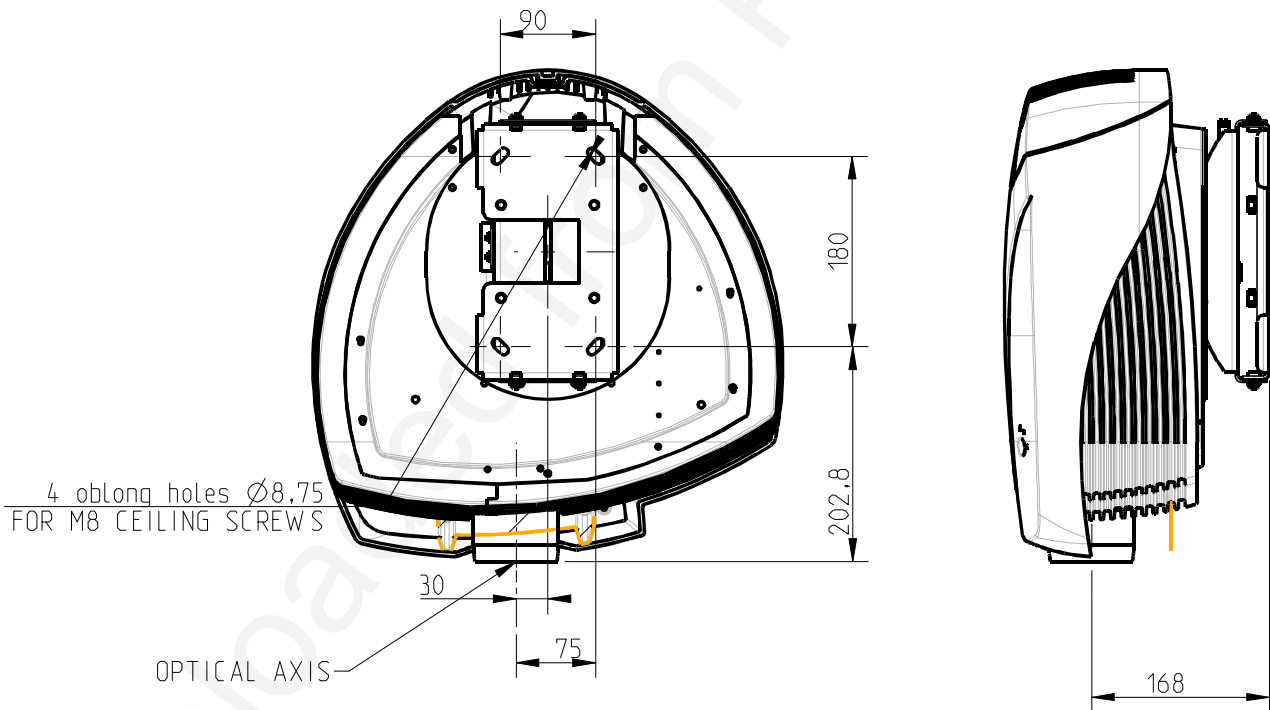

Dimension of ceiling holes with respect to lens of CV80

Mounting the Assembly

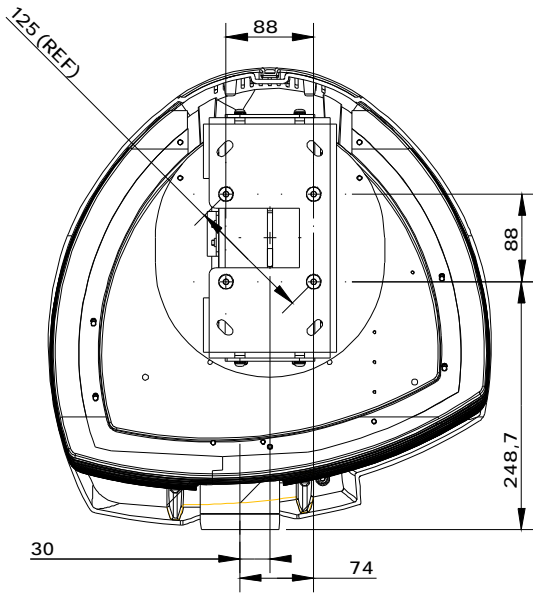

Dim 168 with short IQ bar
R9821260 will be
min $400+168=568$ mm
max. $765+168=933$ mm

Dim 168 with short IQ bar
R9821261 will be
min $800+168=968$ mm
max. $1165+168=1333$ mm

Dimension of ceiling holes with respect to lens of CV80 with ceiling mount IQ BAR R9841260 and R9841261

Illustrations

Separate the Ceiling mount from the packaging and open the top and bottom part by opening the 4 screws as shown

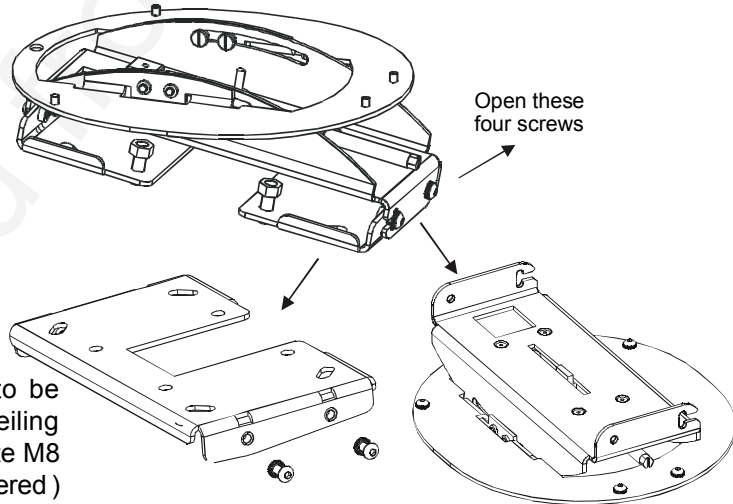

This plate is to be fixed to the ceiling with appropriate M8 bolts (not delivered)

This is attached to the projector with 4 no. M5 bolts given.

These four holes are to be used when height adjustment bar is used.

These four slots are for fixing to the ceiling, use appropriate bolts (M8)

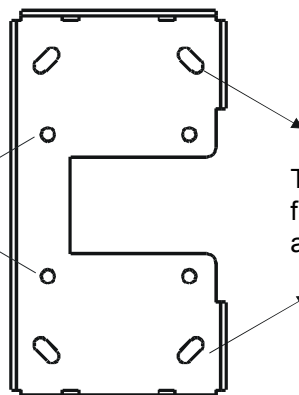

Mounting the Assembly

Mounting the base plate to the projector

Fix the ceiling plate to the ceiling, and assemble the base plate to the projector as shown.

Step	Action	Image
1	Fix the spacer and bearing on the underside of the projector as shown.	1
2	While fixing the base plate to the projector take care that the lead nut shaft passes through the bearing while assembling. If necessary shift the lead nut by rotating the lead shaft screw with the nut spanner.	2

Illustrations

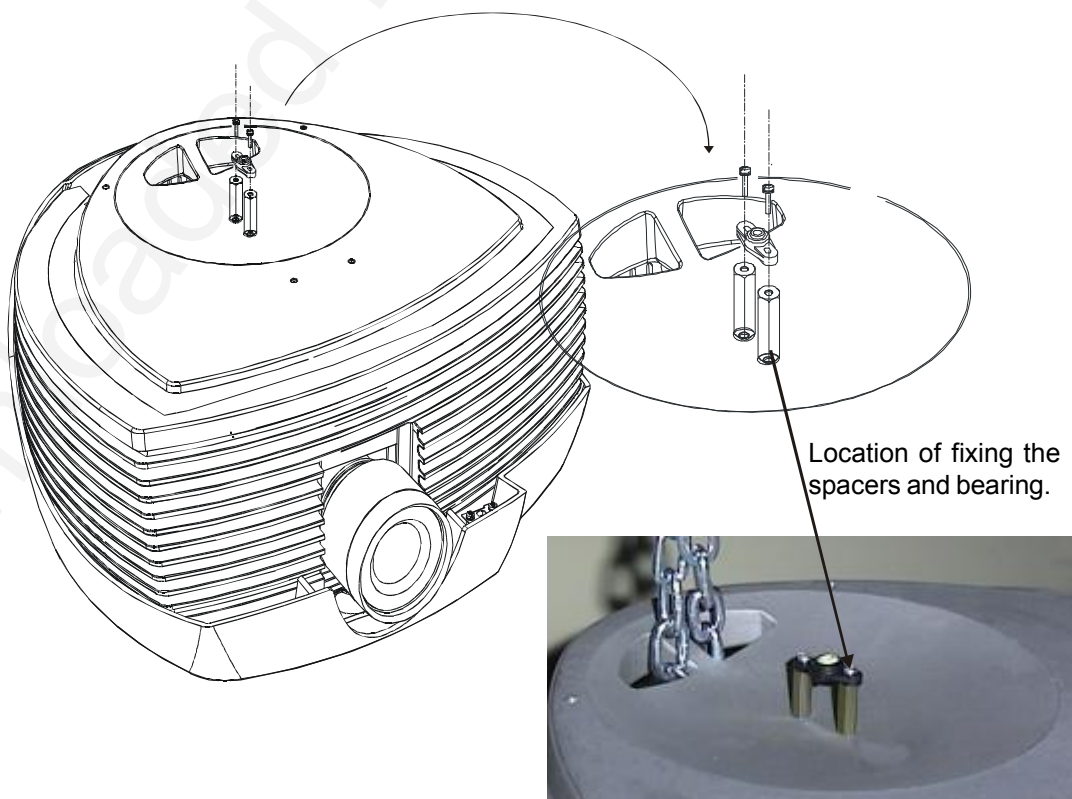
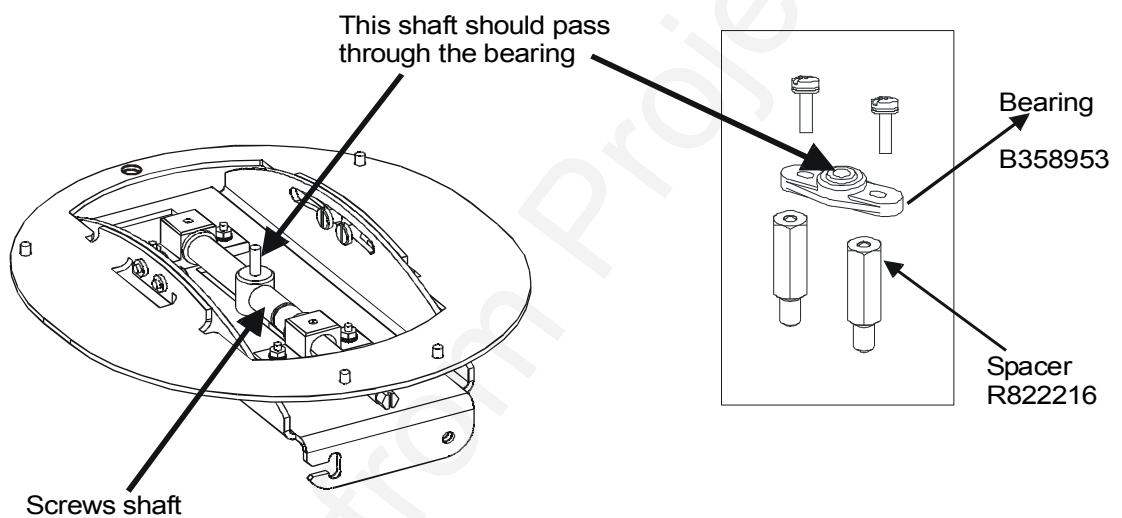

Mounting the Assembly

Mounting the assembly

The assembled projector is then lifted and hooked to the ceiling plate as shown.

Step	Action	Image
1	Fix the ceiling plate to the ceiling at the pre-determined position.	
2	Fix the base plate to the projector with 4 M5 bolts given.	
3	Fix the two screws to the ceiling mount as shown.	
4	Lift the assembled projector and hang it on the screw of the ceiling mount.	
5	Rotate and lift the projector and fix the rest two screws. Tighten the screws as required.	

Illustrations

Fix this plate to the ceiling and put on the two screws shown

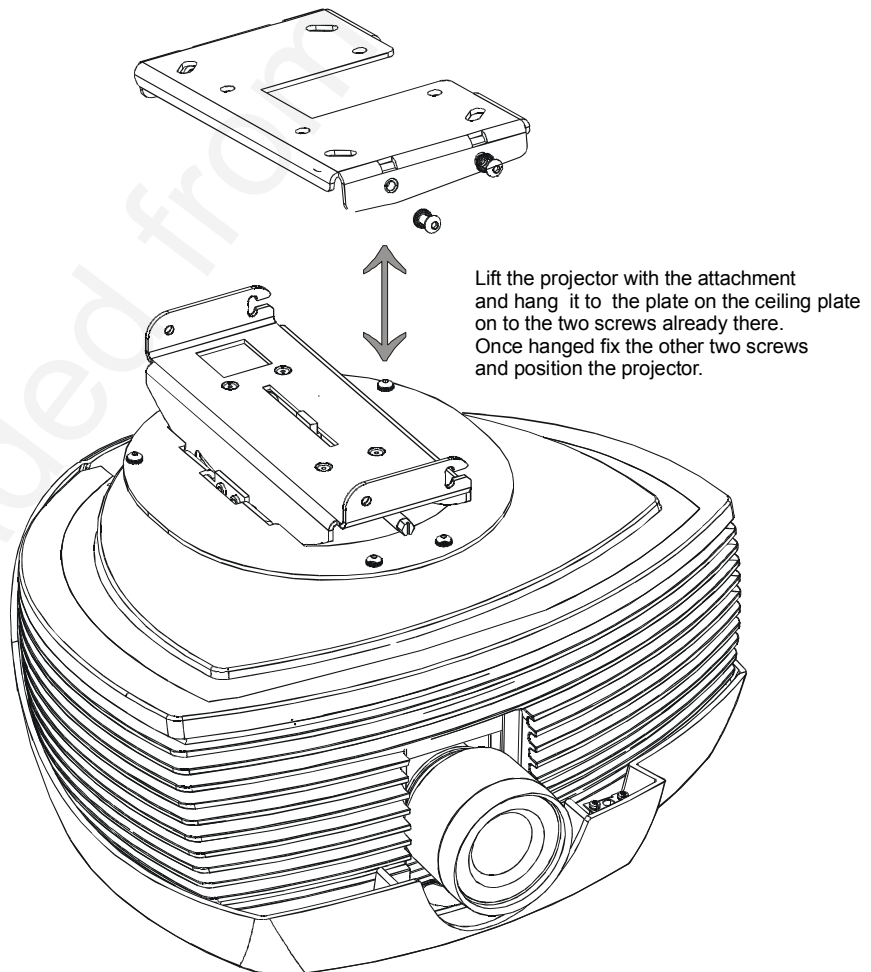

Adjustments

What has to be done If necessary the assembly can be adjusted (positioned) following adjustment are possible:
-horizontal shift
-tilt in 2 planes (length axis and width axis)

Necessary Tools Allan (hexagonal) key (n°4), nut spanner 8mm.

Adjustment To perform adjustment of the assembly follow the next procedure:

Adjust the projector alignments until the desired image is obtained. Tighten all the bolts after the desired image is achieved.

Illustrations

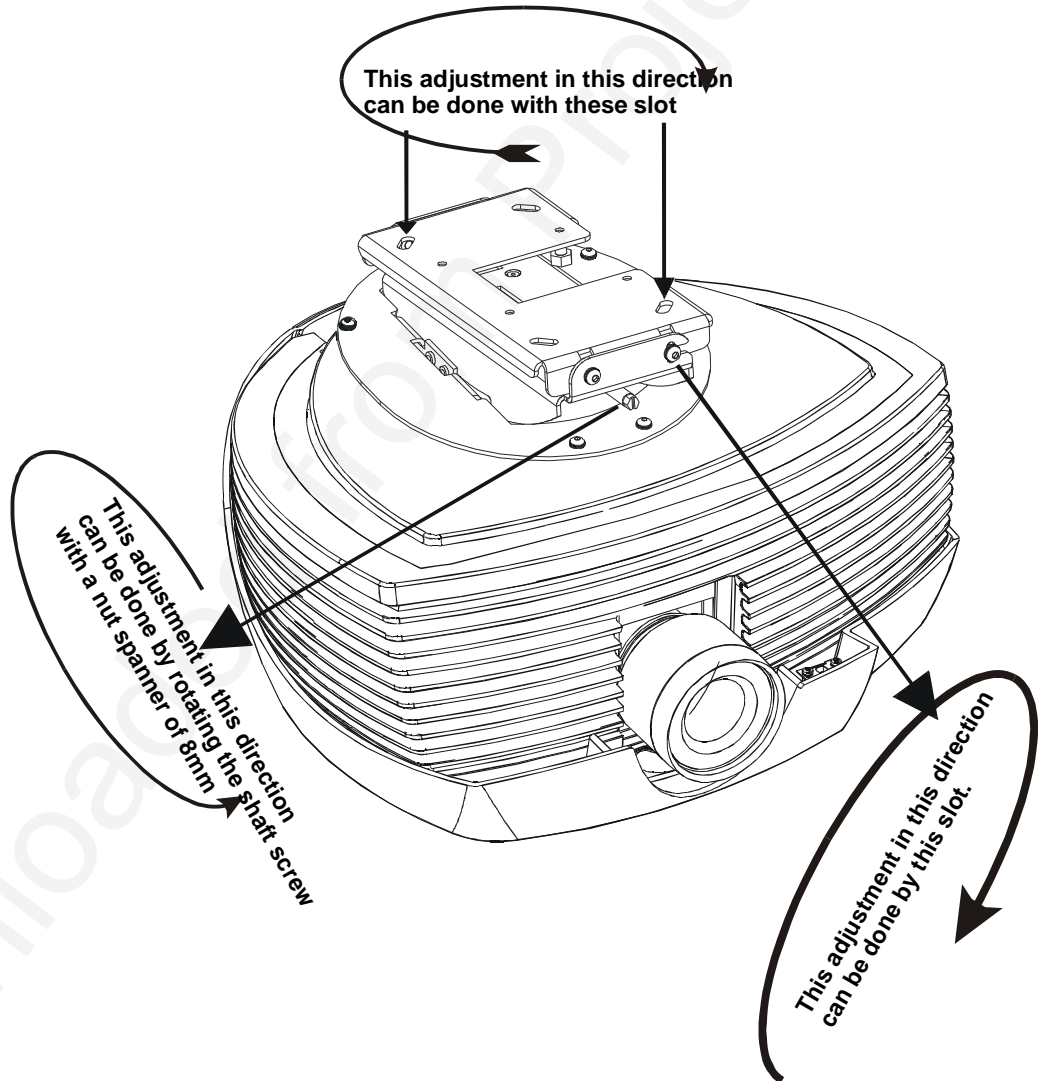

Fixing safety chain

The safety chain can be attached to the projector in the location as shown

Safety Chain

Step	Action	Image
1	The safety chain provided should be attached to the projector as shown in fig.	1
2	Fix the other end of the safety chain on a firm place on the ceiling in a similar manner.	1
3	Use the M8 nuts, bolts and washers to lock the chain.	

Illustrations

M8 nut, bolt and washer used to lock the chain.

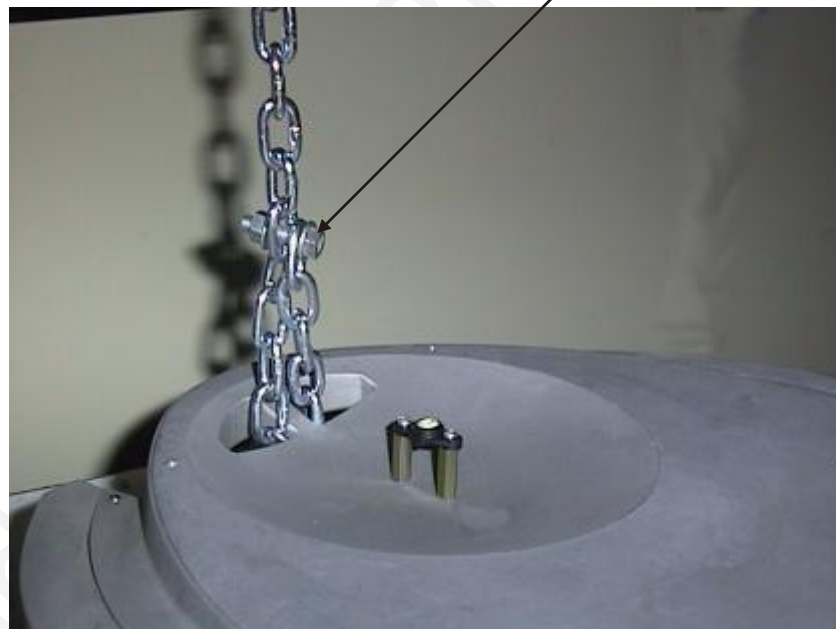

- i) Check the stability of the ceiling mount.
- ii) The installation is complete after a proper image at the desired place is achieved.

PLEASE READ

This manual is provided as a free service by Projector.com.

We are in no way responsible for the contents of the manual. We do not guarantee its accuracy and we do not make any claim of copyright. The copyright remains the property of their respective owners.

ABOUT PROJECTOR.COM

Projector.com (<http://www.projector.com>) is your review and buying guide resource for DLP and LCD video projectors.

Visit the site to read the latest projector news and reviews, read and comment on projector specifications, download user manuals and much more.